

1-1/2" NPT FULL PORT BALL VALVE



TECHNICAL DATA

DESCRIPTION:
1-1/2" NPT Full Port Ball Valve with Threaded Ends

CONSTRUCTION:
Lead Free Brass Body and Brass Stem, Carbon Steel Handle, PTFE Seal

FEATURE:
600 WOG, 125 PSI
Minimum temperature (water): 5°C
Maximum temperature (water): 80°C
Thread ends complies with ANSI B1.20.1
Designed for residential use with water or gas

CODE APPROVALS:
CUPC Listed. Complies w/ NSF-61, NSF-372

PART#	DESCRIPTION	FINISH
BV-NPT-112	1-1/2" NPT Full Port Ball Valve with Threaded Ends	Forged

Country of origin: China

ROUGH IN DRAWING

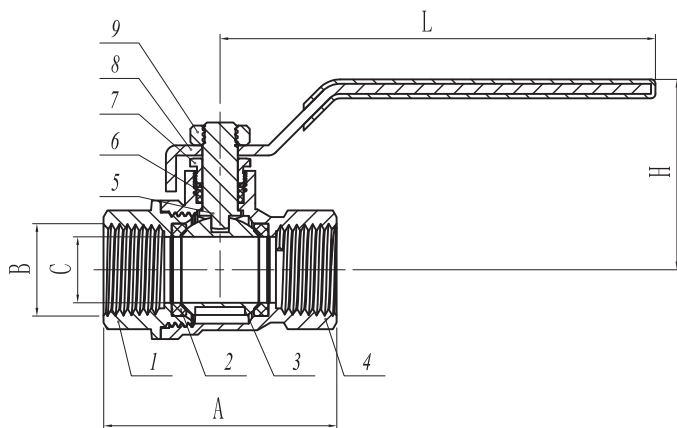

Unit:mm

Size	A	C	H	L
1-1/2"	90	Φ37.2	74	139

No.	Item	Material	Qty
9	Locknut	Stainless Steel	1
8	Handle	Carbon Steel/SS304	1
7	Packing Nut	Brass	1
6	Packing	PTFE	1
5	Stem	Brass	1
4	Body	Lead Free Brass	1
3	Ball	Lead Free Brass	1
2	Seal	PTFE	1
1	Bonnet	Lead Free Brass	1

ALL DIMENSIONS SHOWN ARE NOMINAL

Meets requirements for NSF-61, NSF-372