

# F1960 COLD EXPANSION BALL VALVE WITH DRAIN



## TECHNICAL DATA

### DESCRIPTION:

1/2" F1960 Cold Expansion Ball Valve With Drain

### CONSTRUCTION:

Lead Free Brass Body and Cap, Brass Packing Nut, Stem and Screw, Plated Steel Handle and Lock Washer and Handle Nut, PTFE Seat and Packing

### FINISH:

Forged Brass finish

### CODE APPROVALS:

UPC approved. Complies w/ NSF-61

### PACKAGING:

Color Box w/ Barcode

Inner carton: 10

Master carton: 100

### PART#

BV-EXP-WD-12

### DESCRIPTION

1/2" F1960 Cold Expansion Ball Valve with Drain

### FINISH

FORGED

Country of origin: China

## ROUGH IN DRAWING

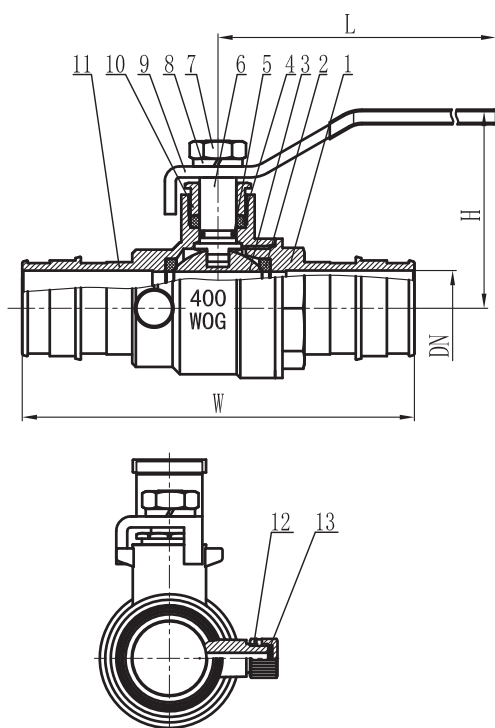

Size	DN	W	H	L
1/2"	10	73.5	42.7	88

13	Gasket	EPDM	1
12	Screw	Brass	1
11	Body	Lead Free Brass	1
10	Packing Nut	Brass	1
9	Handle	Plated Steel	1
8	Lock Washer	Plated Steel	1
7	Handle Nut	Plated Steel	1
6	Stem	Brass	1
5	O-Ring	NBR	1
4	Packing	PTFE	1
3	Ball	Stainless Steel	1
2	Seat	PTFE	2
1	Cap	Lead Free Brass	1
No.	Name	Material	Qty

ALL DIMENSIONS SHOWN ARE NOMINAL

Meets requirements for NSF-61

